

Outlet [type F] Jeweller user manual

Updated November 30, 2023



Outlet [type F] Jeweller is a wireless smart wall outlet with power consumption monitor. Compliant with the European plug type F, it features a grounding terminal and protective shutters. These shutters shield against dust and splashes, and also protect children from electric shock by preventing them from inserting objects like screwdrivers, scissors, or pins into the outlet. The outlet has three types of protection: voltage, current, and temperature.

The smart outlet controls the power supply of electrical appliances connected to it, with a load capacity of up to 3 kW. It can be operated using the Ajax app, through automation scenarios, via the outlet's touch button, or by pressing [Button](#) or smart switch LightSwitch.

We value your privacy

We use cookies to enhance your browsing experience, serve personalized ads or content, and analyze our traffic. By clicking "Accept All", you consent to our use of cookies. [Cookie Policy](#).

Customize ▼

Reject All

Accept All

The device is compatible only with Ajax radio signal range extenders and hubs.
Connection to [uartBridge](#) and [ocBridge Plus](#) is not supported.



A smart outlet for a type E plug is also available – Outlet [type E] Jeweller.

Buy Outlet [type F] smart outlet

Design

Outlet [type F] Jeweller is a prefabricated device that consists of the following components:

- Relay OutletCore (smart) [type F] Jeweller;
- Cover options: SoloCover (smart) [type F] / SideCover (smart) [type F] / CenterCover (smart) [type F];
- Frame options: Frame (2 seats) / Frame (3 seats) / Frame (4 seats) / Frame (5 seats). These frames are used when installing multiple smart outlets and/or LightSwitch devices in a row.



All components are sold separately and can be installed by attaching them to each other.

Choose the appropriate cover for Outlet [type F] based on your installation plan:

- as a separate device – **SoloCover (smart) [type F]**;
- to the right or left of other Outlets or LightSwitches – **SideCover (smart)**

We value your privacy

We use cookies to enhance your browsing experience, serve personalized ads or content, and analyze our traffic. By clicking "Accept All", you consent to our use of cookies. [Cookie Policy](#).



Colours

The product line offers eight cover colour options.



In the outlet settings in the Ajax apps, you can select the colour for Outlet [type F]. Note that the selected colour in the app does not necessarily have to match the actual colour of the installed cover.

An admin or a PRO with the rights to configure the system can change the cover colour at any time. This can be useful, for example, if the user has replaced the cover or wants to differentiate outlets in the app by colour.

Functional elements

Relay

OutletCore (smart) [type F] Jeweller

We value your privacy

We use cookies to enhance your browsing experience, serve personalized ads or content, and analyze our traffic. By clicking "Accept All", you consent to our use of cookies. [Cookie Policy](#).



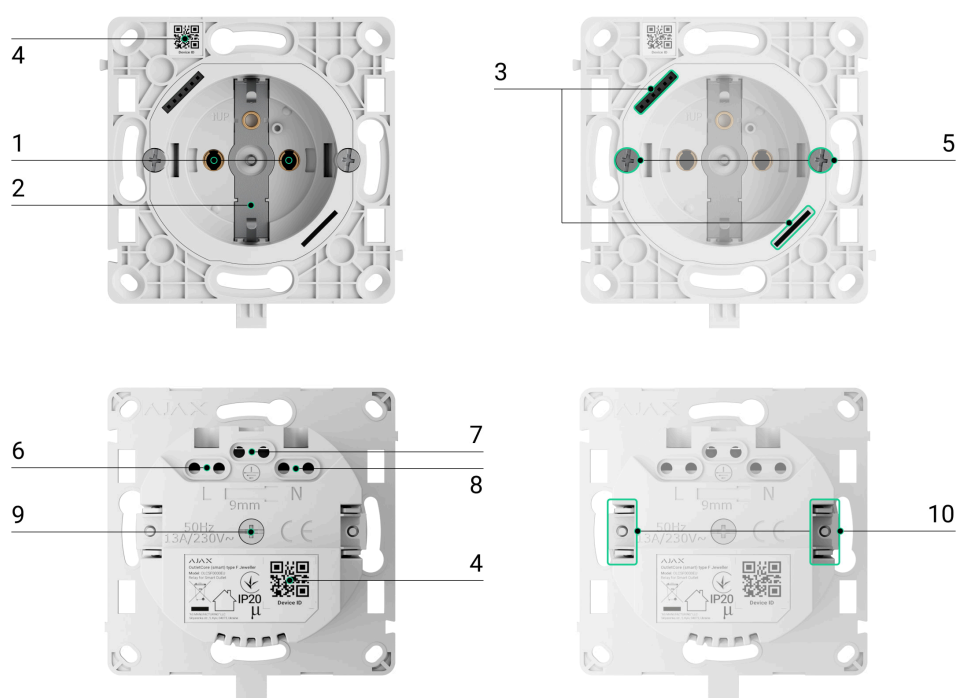

1. Outlet (type F).
2. Grounding terminal.
3. A connector for connecting the LED indication, night backlight, and touch button, which are built into the front panel of the cover.
4. QR code with the device ID for adding the outlet to the Ajax system.
5. Screws for fixing mounting claws.
6. Terminal for connecting the power supply phase (L).
7. Terminal for connecting the ground.
8. Terminal for connecting the power supply neutral (N).
9. The hole for securing the receptacle cap with a bundled screw.
10. Mounting claws to secure the outlet in the mounting box.

Covers

We value your privacy

We use cookies to enhance your browsing experience, serve personalized ads or content, and analyze our traffic. By clicking "Accept All", you consent to our use of cookies. [Cookie Policy](#)



CenterCover (smart) [type F]



Frames

Frame (2 seats)



Frame (3 seats)



Frame (4 seats)



Frame (5 seats)



Dimensions

Relay

OutletCore (smart) [type F] Jeweller



We recommend a mounting box with a minimum depth of 50 mm. Please take into account the dimensions of the relay when [selecting a location for installation](#).

38.3 mm



We value your privacy

We use cookies to enhance your browsing experience, serve personalized ads or content, and analyze our traffic. By clicking "Accept All", you consent to our use of cookies. [Cookie Policy](#)



Covers

SoloCover (smart) [type F]



SideCover (smart) [type F]



CenterCover (smart) [type F]



Frames

Frame (2 seats)



Frame (3 seats)



Frame (4 seats)



Frame (5 seats)



Compatible hubs and range extenders

A compatible Ajax hub with the firmware [OS Malevich 2.16](#) and higher is required for the smart outlet to operate.

We value your privacy

We use cookies to enhance your browsing experience, serve personalized ads or content, and analyze our traffic. By clicking "Accept All", you consent to our use of cookies. [Cookie Policy](#).



- [Hub Hybrid \(2G\)](#)
- [Hub Hybrid \(4G\)](#)

Operating principle

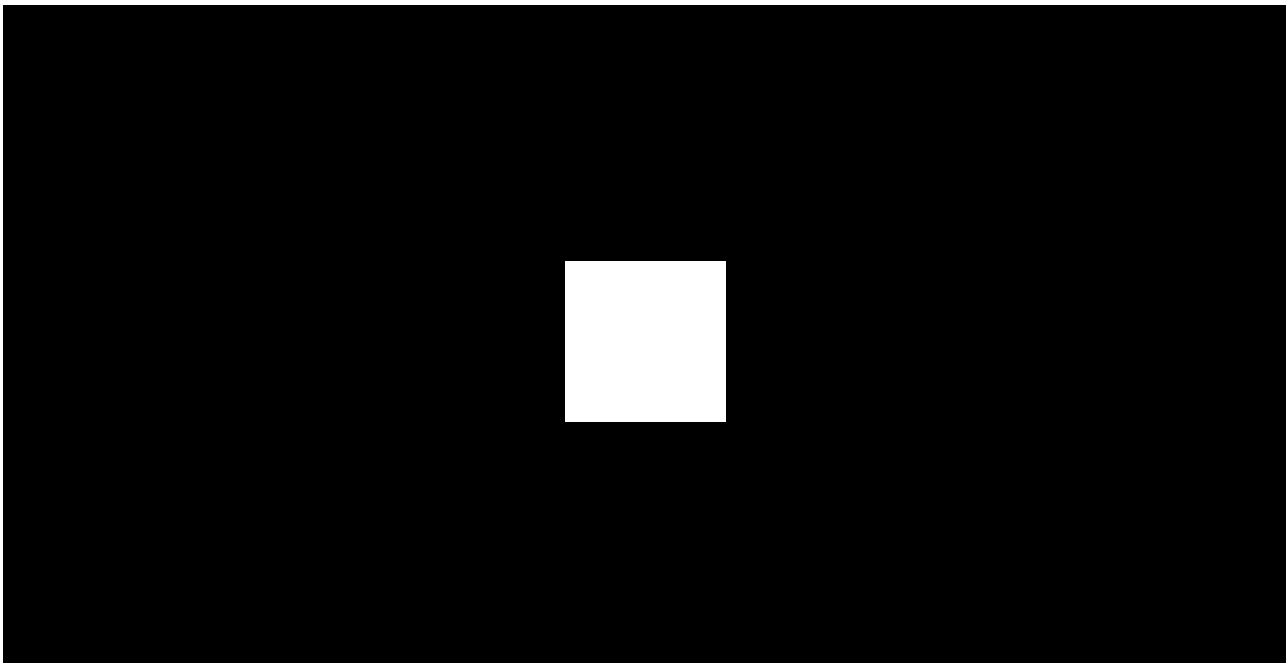

00:00

00:05

Outlet [type F] is a smart outlet of the Ajax system. It controls the power supply to connected devices using [scenarios](#), via the [Ajax app](#), by pressing the touch button on the outlet's body, or with [Button](#) or [LightSwitch](#).

Outlet [type F] monitors the current, voltage, power, and power consumption of connected electrical appliances. This data, along with other operational parameters, can be accessed in the [States](#) section of the Ajax apps. The device status updates approximately every second if Outlet [type F] alters the contact state due to a scenario or after being switched off/on using a touch button or

We value your privacy

We use cookies to enhance your browsing experience, serve personalized ads or content, and analyze our traffic. By clicking "Accept All", you consent to our use of cookies. [Cookie Policy](#).





The maximum long-term load of the plug is 3 kW (if current protection is set at 13 A). If an inductive or capacitive load is connected, the maximum switching current drops to 8 A.

Remote control

Automation scenarios

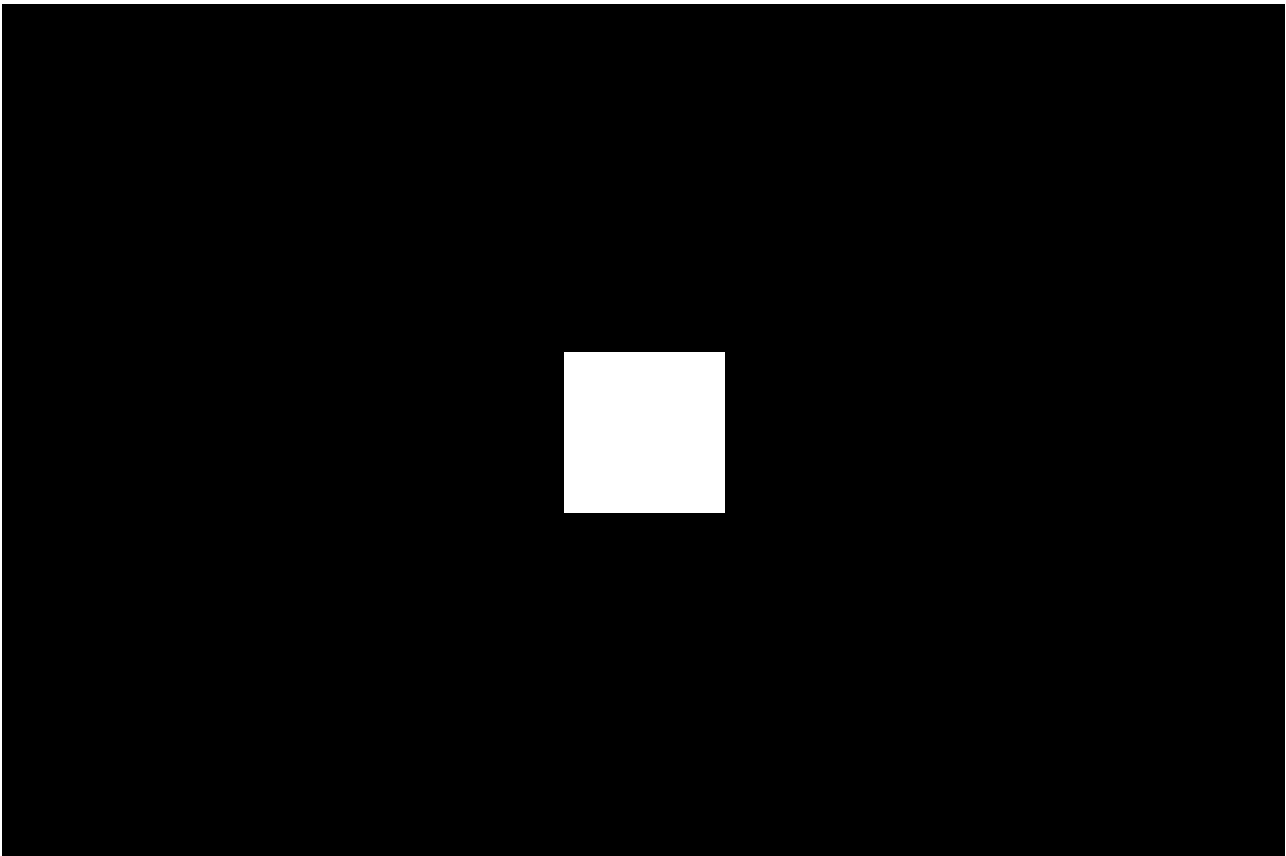

00:00

00:08

Scenarios help to automate security and minimize routine actions. For example, you can schedule the lights, TV, and audio system to turn on at specific times. That way, the house won't seem empty and deter potential intruders.

We value your privacy

We use cookies to enhance your browsing experience, serve personalized ads or content, and analyze our traffic. By clicking "Accept All", you consent to our use of cookies. [Cookie Policy](#).



- **Scheduled actions.** For example, activating the heater at 7:00 PM and turning it off at 9:00 PM.
- **By pressing Button.** For example, illuminating the night light by pressing Button.
- **By temperature.** For example, activating the air conditioner if the room temperature exceeds 25 °C.
- **By humidity level.** For example, initiating the humidifier if the humidity in the room drops below 40%.
- **By CO₂ concentration.** For example, engaging the ventilation system when the carbon dioxide concentration increases.
- **By pressing LightSwitch.** For example, shutting off all electrical appliances when the light is turned off.



Scenarios by humidity and CO₂ concentration are available when [LifeQuality](#) is added to the system.

[Read more about the scenarios](#)

Control via the app

In Ajax apps, you can easily switch connected electrical appliances on or off via Outlet [type F]. Simply click the toggle in the **Outlet [type F]** field found in the **Devices**  tab. This action reverses the current state of the outlet contacts, allowing you to remotely control the power supply to various devices, such as heaters or humidifiers beforehand.

Additionally, you can manage the outlet from the **Control**  tab. Simply swipe

We value your privacy

We use cookies to enhance your browsing experience, serve personalized ads or content, and analyze our traffic. By clicking "Accept All", you consent to our use of cookies. [Cookie Policy](#).



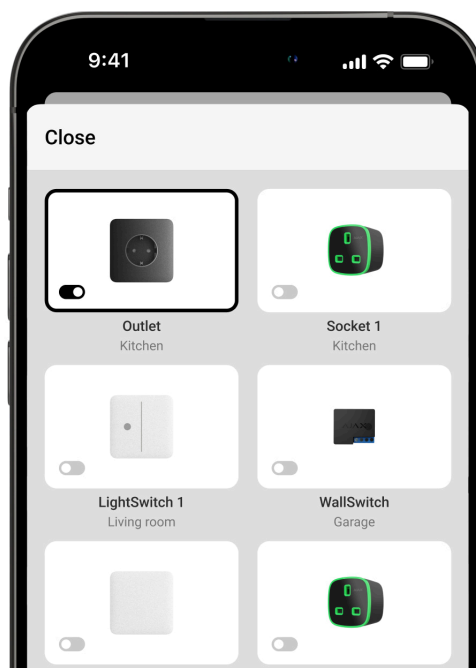

Manual control



The front panel of Outlet [type F] has two **touch buttons** for easy cover installation. After installation, only the button located in the upper left corner of the front cover panel will be active. This touch button allows control of the power supply to connected appliances without the use of the app, scenarios, or

We value your privacy

We use cookies to enhance your browsing experience, serve personalized ads or content, and analyze our traffic. By clicking "Accept All", you consent to our use of cookies. [Cookie Policy](#).



If the **Shutoff by Timer function is activated**, Outlet [type F] supplies power for the time specified in the settings after being turned on with the touch button. Pressing the touch button again will interrupt the command, and the outlet will stop supplying power.

You can activate the touch button in the [socket settings](#) in the Ajax apps. The option is disabled by default.

Operation modes

Outlet [type F] can operate in bistable mode or automatically turn off the power after the expired time. By default, the outlet operates in bistable mode, where it switches on or off as you control the power supply.

When you activate the **Shutoff by Timer** function, the power can be enabled for a specified period: from 10 seconds to 2 hours. This mode is particularly useful, for example, when you need to turn on the lighting in the corridor for 5 minutes upon disarming the security system.

An admin or a PRO, granted the rights to configure the system, can activate the **Shutoff by Timer** function and set the operating time within the [socket settings](#) in Ajax apps.

Types of electrical protection of the outlet



Outlet [type F] offers three independent types of protection: voltage, current, and

We value your privacy

We use cookies to enhance your browsing experience, serve personalized ads or content, and analyze our traffic. By clicking "Accept All", you consent to our use of cookies. [Cookie Policy](#).



overcurrent. The limit can be adjusted within the range of 1 to 16 A, in increments of 1 A, in Outlet [type F] settings. The default value is 13 A.



For regular loads, we recommend setting the current value to up to 13 A. Values between 13 and 16 A should only be used for short-term loads.

Temperature protection: engages when the relay elements' temperature reaches 95 °C, preventing the smart plug from overheating.

If either the voltage or temperature protection is triggered, Outlet [type F] ceases power supply and automatically resumes once the voltage or temperature normalizes. Note that the power supply does not automatically restore when the current protection is triggered. It can be reset by the command in the Ajax app or by pressing the touch button.

Energy consumption monitoring

Outlet [type F] consistently monitors the power consumption parameters of connected devices, including:

- voltage;
- load current;
- power consumption;
- electric energy consumed.

All the data is displayed in the device states. The data updates approximately every second if the outlet alters the contact state according to a scenario or following a toggle off/on by a touch button or a command in the app. In other

We value your privacy

We use cookies to enhance your browsing experience, serve personalized ads or content, and analyze our traffic. By clicking "Accept All", you consent to our use of cookies. [Cookie Policy](#).



2. Select **Outlet [type F]** from the list.
3. Go to **Settings** by clicking on the  icon.
4. Click **Reset Energy Consumption Meter**.
5. Click **Reset** in the pop-up window.

After deleting the data, the date of the last reset will be displayed in the **States** of the outlet.

Jeweller data transfer protocol

This is a two-way wireless data transfer protocol that provides fast and reliable communication between the hub and connected devices. The smart outlet uses Jeweller to transmit alarms and events.

[Learn more](#)

Sending events to the monitoring station

The Ajax system can transmit alarms to both [PRO Desktop](#) monitoring app and the central monitoring station (CMS) in the formats of **SurGard (Contact ID)**, **SIA (DC-09)**, **ADEMCO 685**, and [other protocols](#).

Outlet [type F] can transmit the following events:

1. Loss/restoration of connection between the device and the hub (or radio signal range extender).
2. Permanent deactivation/activation of the outlet.

When an alarm is received, the operator at the security company's CMS knows

We value your privacy

We use cookies to enhance your browsing experience, serve personalized ads or content, and analyze our traffic. By clicking "Accept All", you consent to our use of cookies. [Cookie Policy](#).





The ID and number of the device can be found in its [states in the Ajax app](#).

Adding to the system



Outlet [type F] is incompatible with [Hub](#) and third-party security control panels.

To connect Outlet [type F] to the hub, the outlet must be located at the same secured facility as the system (within the hub's radio network range). When using the [ReX](#) or [ReX 2](#) radio signal range extender, first add the outlet to the hub, then connect it to **ReX** or **ReX 2** in the range extender settings.



The hub and the device operating at different radio frequencies are incompatible. The radio-frequency range of the device may vary by region. We recommend purchasing and using Ajax devices in the same region. You can verify the range of operating radio frequencies with the [technical support service](#).

Before adding a device

1. Install the [Ajax app](#).
2. Create a [user](#) or [PRO](#) account if you don't have one. Add a compatible hub to the app, adjust the necessary settings, and create at least one [virtual room](#).
3. Ensure that the hub is switched on and connected to the internet via Ethernet, Wi-Fi, and/or mobile network.
4. Ensure that the hub is disarmed and does not start updating by checking its [status in the Ajax app](#).

We value your privacy

We use cookies to enhance your browsing experience, serve personalized ads or content, and analyze our traffic. By clicking "Accept All", you consent to our use of cookies. [Cookie Policy](#).



1. **Install** Outlet [type F] and power it.
2. Open the **Ajax app** and select the hub where you want to add the device.
3. Go to the **Devices**  tab and click **Add device**.
4. Name the device, scan or manually input the QR code found on the rear and front panel of OutletCore (smart) [type F] Jeweller, as well as on the device packaging. The device ID is located below the QR code.
5. Select a room and a group (if **Group Mode** is enabled).
6. Click **Add**.

If the connection fails, try again in 5 seconds. If the hub has reached its maximum number of devices (depending on the hub model), you will be notified when you try to add a new one.

Once connected to the hub, the outlet will appear in the list of hub devices in the Ajax app. The device status update frequency in the list depends on the **Jeweller** or **Jeweller/Fibra** settings, with the default value of 36 seconds.



Outlet [type F] works with only one hub. When connected to a new hub, the device stops sending events to the old one. To add an outlet to a new hub:

- scan or manually input the QR code;
- wait for the device registration timer to start counting down and press the touch button on the front panel of the outlet for 3 seconds.

Adding the outlet to a new hub does not automatically remove it from the device list of the old hub. This must be done through the Ajax app.

Malfunctions

We value your privacy

We use cookies to enhance your browsing experience, serve personalized ads or content, and analyze our traffic. By clicking "Accept All", you consent to our use of cookies. [Cookie Policy](#).



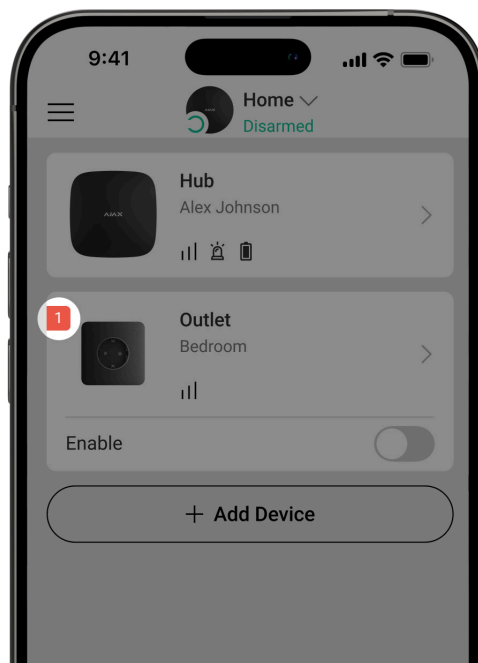

When Outlet [type F] malfunction is detected, the Ajax app displays a malfunction counter on the device icon. All malfunctions are indicated in the outlet's states. Fields with malfunctions will be highlighted in red.

A malfunction is displayed if:

- current protection was activated;
- temperature protection was activated;
- voltage protection was activated;
- there is no connection with the hub or radio signal range extender.

Icons

We value your privacy





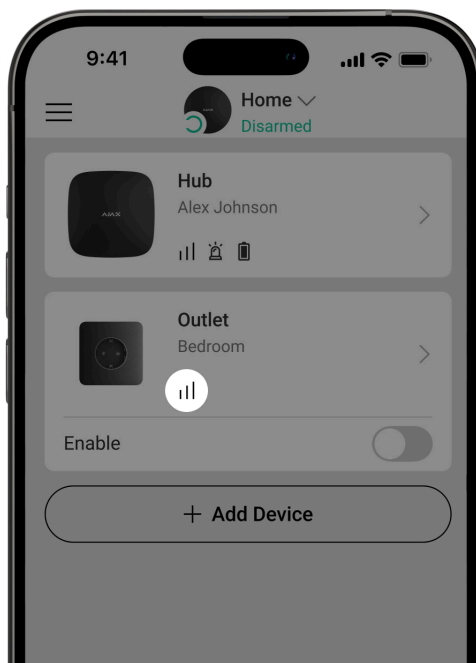

We use cookies to enhance your browsing experience, serve personalized ads or content, and analyze our traffic. By clicking "Accept All", you consent to our use of cookies. [Cookie Policy](#).





The icons in the app display some outlet states. To access them:

1. Sign in to the [Ajax app](#).
2. Select a hub.
3. Go to the **Devices**  tab.

Icon	Value
	Jeweller Signal Strength displays the signal strength between the hub and the outlet.
	Malfunction detected.
	Device is connected via a radio signal range extender .
	Current protection was activated.
	Voltage protection was activated.
	Temperature protection was activated.
	Device is permanently deactivated.

We value your privacy

We use cookies to enhance your browsing experience, serve personalized ads or content, and analyze our traffic. By clicking "Accept All", you consent to our use of cookies. [Cookie Policy](#).



States

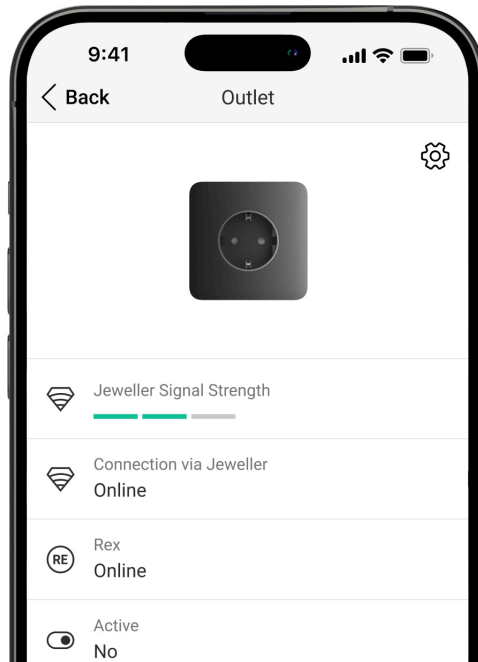

The states include information about the device and its operating parameters. You can find the states of Outlet [type F] in the Ajax app:

1. Go to the **Devices**  tab.
2. Select **Outlet [type F]** from the list.

Parameter	Value
Malfunction	<p>Clicking the  opens the list of the Outlet [type F] malfunctions.</p> <p>The field is displayed only if a malfunction is detected.</p>
Jeweller Signal Strength	<p>Jeweller signal strength between the device and the hub or the radio signal range extender. The recommended value is 2–3 bars.</p>

We value your privacy

We use cookies to enhance your browsing experience, serve personalized ads or content, and analyze our traffic. By clicking "Accept All", you consent to our use of cookies. [Cookie Policy](#)



	<ul style="list-style-type: none"> • Online – the device is connected to the hub or the range extender. Normal state. • Offline – the device is not connected to the hub or the range extender. Check the device connection.
ReX	<p>Connection status between the device and the <u>range extender</u>:</p> <ul style="list-style-type: none"> • Online – the device is connected to the range extender. • Offline – the device is not connected to the range extender. <p>The field is displayed if the plug operates via a radio signal range extender.</p>
Active	<p>Plug state:</p> <ul style="list-style-type: none"> • Yes – device connected to the outlet is energized. • No – device connected to the outlet is de-energized.
Current	<p>The value of current commuted by Outlet [type F].</p> <p>Data update frequency is approximately 1 second if the outlet has changed the contact state according to a scenario or after being switched off/on by a touch button or a command in the app. In other cases, the update frequency depends on the Jeweller or Jeweller/Fibra settings, with the default value of 36 seconds.</p>

We value your privacy

We use cookies to enhance your browsing experience, serve personalized ads or content, and analyze our traffic. By clicking "Accept All", you consent to our use of cookies. [Cookie Policy](#).



	<p>command in the app. In other cases, the update frequency depends on the Jeweller or Jeweller/Fibra settings, with the default value of 36 seconds.</p> <p>The value is displayed in increments of 1 V~.</p>
Current Protection Threshold	<p>The current limit for current protection adjusted in the settings.</p> <p>Once the current exceeds the selected limit, the outlet turns off automatically.</p>
Voltage Protection	<p>Voltage protection state:</p> <ul style="list-style-type: none"> • On – voltage protection is enabled. Once the voltage is outside the range of 184–253 V~, the outlet turns off automatically. • Off – voltage protection is disabled. <p>The relay will automatically continue to operate when voltage returns to normal.</p>
Control Device with Touch Button	<p>Configuration state of the ability to control the outlet with the touch button.</p>
Power	<p>The power consumption of an appliance connected to the plug.</p> <p>Data update frequency is approximately 1 second if the outlet has changed the contact state according to a scenario or after being switched off/on by a touch button or a command in the app. In other cases, the update frequency depends on the Jeweller or Jeweller/Fibra settings, with the default value of 36 seconds.</p> <p>The value is displayed in increments of 1 W.</p>

We value your privacy

We use cookies to enhance your browsing experience, serve personalized ads or content, and analyze our traffic. By clicking "Accept All", you consent to our use of cookies. [Cookie Policy](#).



	<p>frequency depends on the Jeweller or Jeweller/Fibra settings, with the default value of 36 seconds.</p> <p>The value is displayed in kWh, in increments of 1 Wh.</p> <p>You can reset the counter in the outlet Settings. In case of a power loss, the app displays the last saved value.</p>
Last Consumption Reset	<p>The date of the last reset of the energy consumption meter.</p> <p>It is displayed if the meter data has been reset.</p>
Permanent Deactivation	<p>Displays the status of the device's permanent deactivation setting:</p> <ul style="list-style-type: none"> • No – the device operates in normal mode and transmits all events. • Entirely – the device is completely excluded from system operation by the hub admin. It does not execute system commands or report alarms and other events. <p>Learn more</p>
One-Time Deactivation	<p>Displays the status of the device's one-time deactivation setting:</p> <ul style="list-style-type: none"> • No – the device operates in normal mode. • Entirely – the device is completely excluded from system operation until the first disarm. It does not execute system commands or report alarms and other events.

We value your privacy



We use cookies to enhance your browsing experience, serve personalized ads or content, and analyze our traffic. By clicking "Accept All", you consent to our use of cookies. [Cookie Policy](#)

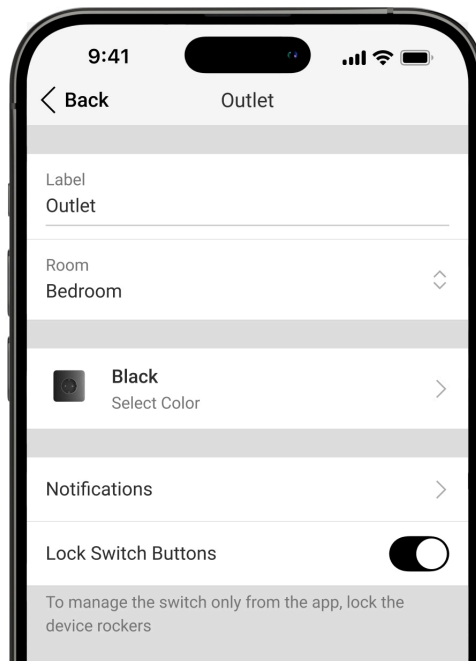

Settings



To change the Outlet [type F] settings, in the Ajax app:

1. Go to the **Devices**  tab.
2. Select **Outlet [type F]** from the list.
3. Go to **Settings** by clicking on the  icon.
4. Set the required parameters.
5. Click **Back** to save the new settings.

Settings	Value
Name	Name of the outlet. Displayed in the list of hub devices, SMS text, and notifications in the events feed. To change the name of the device, click on the text field

We value your privacy

We use cookies to enhance your browsing experience, serve personalized ads or content, and analyze our traffic. By clicking "Accept All", you consent to our use of cookies. [Cookie Policy](#).



	The room name is displayed in SMS text and notifications in the events feed.
Colour	<p>Selecting a colour for the outlet icon in the app. The following 8 colours are available:</p> <ul style="list-style-type: none"> • Black. • White. • Fog. • Grey. • Oyster. • Olive. • Graphite. • Ivory. <p>The list of colours corresponds to the colours of the covers.</p>
Notifications	<p>Selecting the outlet in-app notifications:</p> <ul style="list-style-type: none"> • When turned on/off – enable the option if you want to receive notifications when the device switches its state. • When scenario executed – enable the option if you want to be notified in the app when the outlet executes a scenario.
Control Device with Touch Button	When enabled, you can switch the outlet's state with a touch button on its front panel. This option is disabled by default.
Current Protection Threshold	Selecting the maximum current computed by

We value your privacy

We use cookies to enhance your browsing experience, serve personalized ads or content, and analyze our traffic. By clicking "Accept All", you consent to our use of cookies. [Cookie Policy](#).



	<p>If the set value is exceeded, the current protection activates, and the outlet stops supplying power to the electrical appliance connected to it.</p> <p>You can restore the power supply manually in the Ajax app or by pressing the outlet's touch button.</p>
Voltage protection	When enabled, the power of the appliance connected to the outlet will be cut off if voltage exceeds 184–253 V~.
Backlight	Setting the backlight of the outlet frame: enabled or disabled.
Indication	<p>Settings for the outlet's LED indication:</p> <ul style="list-style-type: none"> • Off – the LED indication is off. • Always – the LED indication is always active, regardless of whether the smart outlet is active (power is supplied to the connected device). This option is set by default. • When enabled – the LED indication is only active when the smart outlet is active (power is supplied to the connected device). When the outlet is inactive, the LED indication turns off.
LED Brightness	<p>Adjusting the brightness of the smart outlet's LED indication: from 0 to 100 (0 – minimal brightness, 100 – very bright).</p> <p>The brightness level is 50% by default.</p> <p>Available if the Always or When enabled option is selected in the Indication settings.</p>

We value your privacy

We use cookies to enhance your browsing experience, serve personalized ads or content, and analyze our traffic. By clicking "Accept All", you consent to our use of cookies. [Cookie Policy](#).



	Available if the Shutoff by Timer toggle is enabled.
Reset Energy Consumption Meter	Menu to reset energy consumption data.
Scenarios	<p>Opens the menu for creating and configuring automation scenarios.</p> <p>Use scenarios to automate security. For example, to switch on lighting in the facility when an opening detector is triggered.</p> <p>Learn more</p>
Jeweller Signal Strength Test	<p>Switches the device to the Jeweller signal strength test mode.</p> <p>Learn more</p>
User Manual	Opens the Outlet [type F] user manual in the Ajax app.
Permanent Deactivation	<p>Allows the user to deactivate the device without removing it from the system.</p> <p>Two options are available:</p> <ul style="list-style-type: none"> • No – the device operates in normal mode and transmits all events. • Entirely – the device does not execute system commands or participate in automation scenarios; additionally, the system ignores alarms and other device notifications. <p>After deactivation, Outlet [type F] retains the state it had at the time of disconnection: active or inactive.</p>

We value your privacy

We use cookies to enhance your browsing experience, serve personalized ads or content, and analyze our traffic. By clicking "Accept All", you consent to our use of cookies. [Cookie Policy](#).



	<ul style="list-style-type: none"> • Entirely – the device is completely excluded from system operations until the first disarm. The device does not execute system commands or report alarms and other events. <p>After deactivation, Outlet [type F] retains the state it had at the time of disconnection: active or inactive.</p> <p>Learn more</p>
Unpair Device	Unpairs the device, disconnects it from the hub, and deletes its settings.

Indication

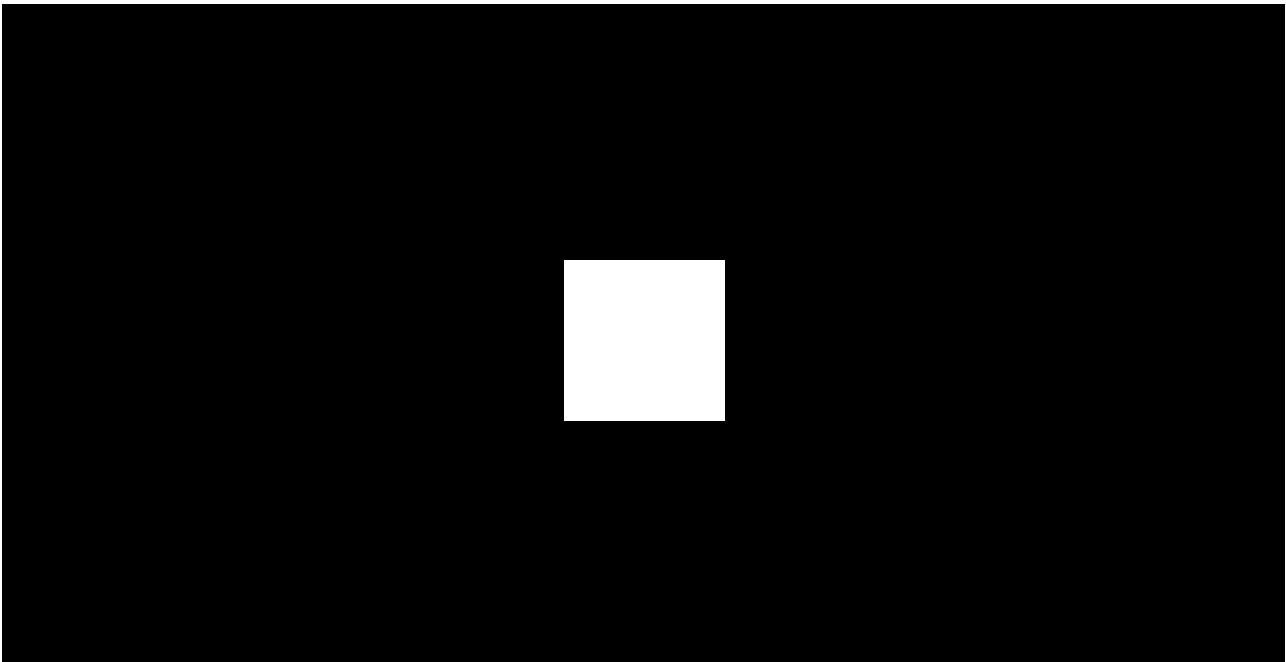

00:00

00:07

Outlet [type F] informs about its state and the power consumption of connected

We value your privacy

We use cookies to enhance your browsing experience, serve personalized ads or content, and analyze our traffic. By clicking "Accept All", you consent to our use of cookies. [Cookie Policy](#)





Outlet [type F] is off	Lights up blue
Outlet [type F] is on, load from 0 to 549 W is connected	Lights up green
From 550 to 1,249 W	Lights up yellow
From 1,250 to 1,999 W	Lights up orange
From 2,000 to 2,839 W	Lights up red
From 2,840 to 3,679 W	Lights up dark red
3,680 W and above	Lights up purple
Activates one or more types of protection (e.g., current and/or voltage)	Slowly lights up red and goes out

Functionality testing

The Ajax system offers several types of tests to assist in selecting the optimal installation location for the devices. These tests do not start immediately; however, the waiting time does not exceed the duration of one “hub–device” polling interval. You can check and configure the polling interval in the hub settings (**Hub** → **Settings**  → **Jeweller** or **Jeweller/Fibra**).

To run a test, in the Ajax app:

1. Select the required hub.
2. Go to the **Devices**  tab.
3. Select **Outlet [type F]** from the list.
4. Go to the **Settings** .
5. Select and run the **Jeweller Signal Strength Test**.

We value your privacy

We use cookies to enhance your browsing experience, serve personalized ads or content, and analyze our traffic. By clicking "Accept All", you consent to our use of cookies. [Cookie Policy](#).





When choosing a location for the device, consider the parameters that affect its operation:

- Jeweller signal strength;
- the distance between the outlet and the hub or range extender;
- the presence of barriers that might hinder radio signal transmission between devices, such as walls, interfloor ceilings, or large objects located in the premises.

Consider the placement recommendations when designing the security system project for your object. The security system should be designed and installed by professionals. A list of recommended partners is [available here](#).

Signal strength

The Jeweller signal strength is determined by the number of undelivered or corrupted data packages over a certain period of time. The icon  on the **Devices**  tab indicates the signal strength:

- **three bars** – excellent signal strength;
- **two bars** – good signal strength;
- **one bar** – low signal strength, stable operation is not guaranteed;
- **crossed out icon** – no signal.



Check the Jeweller signal strength before the final installation. With a signal strength of one or zero bars, we do not guarantee stable operation of the device. Consider relocating the device, as adjusting its position even by 20 cm can significantly improve the signal strength. If the signal remains poor or unstable after relocation, consider using [ReX](#) or [ReX 2](#) radio signal range extender.

We value your privacy

We use cookies to enhance your browsing experience, serve personalized ads or content, and analyze our traffic. By clicking "Accept All", you consent to our use of cookies. [Cookie Policy](#).



2. Nearby any metal objects or mirrors, which can cause signal attenuation and screening.
3. Inside premises with temperature and humidity levels outside the permissible limits, as this can damage the device.
4. Closer than 1 meter to the hub or radio signal range extender, to prevent a communication loss with the outlet.
5. In areas with low signal levels, as this may result in connection loss with the hub.

Installation

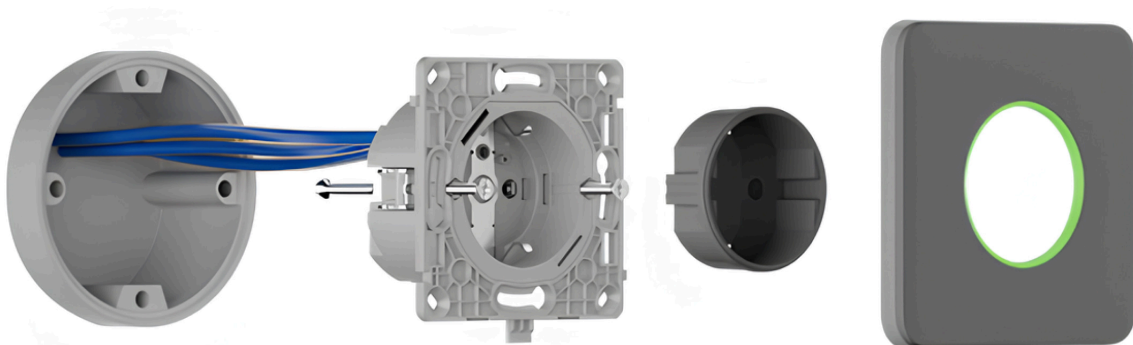

Before installing Outlet [type F], make sure that you have selected the optimal location that complies with the requirements of this manual. When installing and operating the device, follow the general electrical safety rules for using electrical appliances, as well as the requirements of electrical safety regulations.

Only a qualified electrician or installer should install Outlet [type F]. Avoid energizing the power to the smart outlet until the cover has been securely installed.

To mount Outlet [type F]:

1. De-energize the power cable to which Outlet [type F] will be connected.

We value your privacy

We use cookies to enhance your browsing experience, serve personalized ads or content, and analyze our traffic. By clicking "Accept All", you consent to our use of cookies. [Cookie Policy](#).



4. Connect the cables to **OutletCore (smart) [type F] Jeweller** relay as per the following wiring diagrams:

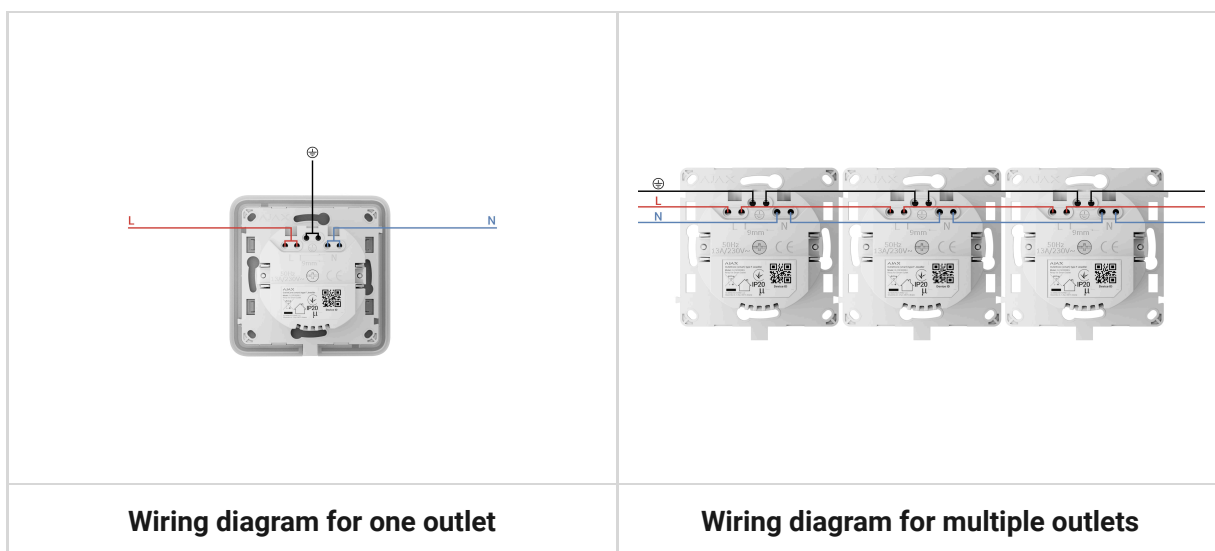

1. Connect the power supply phase to terminal **L**.
2. Connect the power supply neutral to terminal **N**.
3. Connect the grounding cable to the designated terminal \oplus .
5. Install the **OutletCore** relay in the mounting box and carefully insert cables. Tighten the screws to secure the mounting claws. Fasten the outlet relay using the bundled screws.
6. Install the remaining **OutletCore** relays, if necessary.
7. If installing multiple outlets or LightSwitch switches, mount the frame with the appropriate number of seats.
8. Install the necessary front panels.
9. Switch on power.
10. Add outlets to the hub using the Ajax app.

Outlet [type F] will turn on within 3 seconds after power is applied. You will hear

We value your privacy

We use cookies to enhance your browsing experience, serve personalized ads or content, and analyze our traffic. By clicking "Accept All", you consent to our use of cookies. [Cookie Policy](#)



Regularly check the functioning of the device. Clean the device's enclosure to remove dust, cobwebs, and other contaminants as they emerge. Use a soft, dry cloth suitable for cleaning electronic equipment. Avoid using substances that contain alcohol, acetone, petrol, and other active solvents when cleaning the device.

Technical specifications

All technical specifications of Outlet [type F] Jeweller

Compliance with standards

Complete set

Outlet [type F] Jeweller is a prefabricated smart outlet. All parts are purchased separately.

1. OutletCore (smart) [type F] Jeweller
2. SoloCover (smart) [type F]*
3. SideCover (smart) [type F]*
4. CenterCover (smart) [type F]*
5. Frame*
6. Installation kit
7. Quick Start Guide

* – depends on the kit.

We value your privacy

We use cookies to enhance your browsing experience, serve personalized ads or content, and analyze our traffic. By clicking "Accept All", you consent to our use of cookies. [Cookie Policy](#).



[Warranty obligations](#)

[User Agreement](#)

Contact Technical Support:

- [e-mail](#)
- [Telegram](#)

Subscribe to the newsletter about safe life. No spam

Subscribe

We value your privacy

We use cookies to enhance your browsing experience, serve personalized ads or content, and analyze our traffic. By clicking "Accept All", you consent to our use of cookies. [Cookie Policy](#).

