

Product Information

©2021 Hangzhou Hikvision Digital Technology Co., Ltd. All rights reserved.

About this Manual
The Manual includes instructions for using and managing the Product. Pictures, charts, images and all other information hereinafter are for description and explanation only. The information contained in the Manual is subject to change, without notice, due to firmware updates or other reasons. Please find the latest version of this Manual at the Hikvision website (<https://www.hikvision.com/>).

Please use this Manual with the guidance and assistance of professionals trained in supporting the Product.

Trademarks
HIKVISION and other Hikvision's trademarks and logos are the properties of Hikvision in various jurisdictions. Other trademarks and logos mentioned are the properties of their respective owners.

CE This product and - if applicable - the supplied accessories too are marked with "CE" and comply therefore with the applicable harmonized European standards listed under the RE Directive 2014/53/EU, the EMC Directive 2014/30/EU, the LVD Directive 2014/35/EU, the RoHS Directive 2011/65/EU.

⚠️ The Input voltage should meet both the SELV (Safety Extra Low Voltage) and the Limited Power Source according to the IEC60950-1 standard. Please refer to technical specifications for detailed information.

♻️ 2012/19/EU (WEEE directive): Products marked with this symbol cannot be disposed of as unsorted municipal waste in the European Union. For proper recycling, return this product to your local supplier upon the purchase of equivalent new equipment, or dispose of it at designated collection points. For more information see: www.recyclethis.info

Disclaimer
TO THE MAXIMUM EXTENT PERMITTED BY APPLICABLE LAW, THIS MANUAL AND THE PRODUCT DESCRIBED, WITH ITS HARDWARE, SOFTWARE AND FIRMWARE, ARE PROVIDED "AS IS" AND "WITH ALL FAULTS AND ERRORS". HIKVISION MAKES NO WARRANTIES, EXPRESS OR IMPLIED, INCLUDING WITHOUT LIMITATION, MERCHANTABILITY, SATISFACTORY QUALITY, OR FITNESS FOR A PARTICULAR PURPOSE. THE USE OF THE PRODUCT BY YOU IS AT YOUR OWN RISK. IN NO EVENT WILL HIKVISION BE LIABLE TO YOU FOR ANY SPECIAL, CONSEQUENTIAL, INCIDENTAL, OR INDIRECT DAMAGES, INCLUDING, AMONGST OTHERS, DAMAGES FOR LOSS OF BUSINESS PROFITS, BUSINESS INTERRUPTION, OR LOSS OF DATA, CORRUPTION OF SYSTEMS, OR LOSS OF DOCUMENTATION, WHETHER BASED ON BREACH OF CONTRACT, TORT (INCLUDING NEGLIGENCE), PRODUCT LIABILITY, OR OTHERWISE, IN CONNECTION WITH THE USE OF THE PRODUCT, EVEN IF HIKVISION HAS BEEN ADVISED OF THE POSSIBILITY OF SUCH DAMAGES OR LOSS.

YOU ACKNOWLEDGE THAT THE NATURE OF THE INTERNET PROVIDES FOR INHERENT SECURITY RISKS, AND HIKVISION SHALL NOT TAKE ANY RESPONSIBILITIES FOR ABNORMAL OPERATION, PRIVACY LEAKAGE OR OTHER DAMAGES RESULTING FROM CYBER-ATTACK, HACKER ATTACK, VIRUS INFECTION, OR OTHER INTERNET SECURITY RISKS; HOWEVER, HIKVISION WILL PROVIDE TIMELY TECHNICAL SUPPORT IF REQUIRED.
YOU AGREE TO USE THIS PRODUCT IN COMPLIANCE WITH ALL APPLICABLE LAWS, AND YOU ARE SOLELY RESPONSIBLE FOR ENSURING THAT YOUR USE CONFORMS TO THE APPLICABLE LAW. ESPECIALLY, YOU ARE RESPONSIBLE FOR USING THIS PRODUCT IN A MANNER THAT DOES NOT INFRINGE ON THE RIGHTS OF THIRD PARTIES, INCLUDING WITHOUT LIMITATION, RIGHTS OF PUBLICITY, INTELLECTUAL PROPERTY RIGHTS, OR DATA PROTECTION AND OTHER PRIVACY RIGHTS. YOU SHALL NOT USE THIS PRODUCT FOR ANY PROHIBITED END-USES, INCLUDING THE DEVELOPMENT OR PRODUCTION OF WEAPONS OF MASS DESTRUCTION, THE DEVELOPMENT OR PRODUCTION OF CHEMICAL OR BIOLOGICAL WEAPONS, ANY ACTIVITIES IN THE CONTEXT RELATED TO ANY NUCLEAR EXPLOSIVE OR UNSAFE NUCLEAR FUEL-CYCLE, OR IN SUPPORT OF HUMAN RIGHTS ABUSES.
IN THE EVENT OF ANY CONFLICTS BETWEEN THIS MANUAL AND THE APPLICABLE LAW, THE LATER PREVAILS.

INSTALLATION CAUTION
1. The additional force shall be equal to three times the weight of the equipment but not less than 50N. The equipment and its associated mounting means shall remain secure during the installation. After the installation, the equipment, including any associated mounting plate, shall not be damaged.
2. Install the equipment according to the instructions in this manual.
3. To prevent injury, this equipment must be securely attached to the wall in accordance with the installation instructions.

English

Diagram Reference

1 Components and Beeps

Indicator				
Set	→	Solid Green: No Configuration	Flashing Green: In the Configuration Status	
Fault	→	Solid Orange: System Fault	Off: No Fault	
Network	→	Solid Green: All Enabled Channels Connected Normally	Off: Part of or All Enabled Channels Connected Abnormally	
Armed/Disarmed	→	Solid Blue: Armed	Off: Disarmed	
Alarm	→	Flashing Red: Alarm Occurred/Tamper Alarm	Off: No Alarm	

Key	Query	Project	Bypass	Medicine	Scroll Up
	Fire	Panic	One-Push to Arm	Scroll Down	

Beeps

One Beep: Pressing keys/command timed out or too long.
Two Beeps: Valid command/Report uploaded.
Five Beeps: Invalid command/Failed to upload the report in 60s.
Continuous Beeping For Two Seconds: Fault prompt (Only for the Network Control Panel)
Slowly Continuous Beeps: In the Entry/Exit delay status.
Rapidly Continuous Beeps: In the Entry/Exit delay status, 10 seconds countdown.
Rapid Beeps: Zone alarm/keypad not enrolled.
Three Long Beeps and Two Short Beeps: Keypad tampered.
Three Beeps: Keypad enrolled.

2 Address Settings

Configure the address via DIP switch of the keypad before powering on the system. The address should be in the range (for Network Control Panel, 0 to 31; for Hybrid Control Panel, 0 to 23). The address of each keypad should be unique. The binary value shown in the diagram is 00010, which means the decimal value is 2. So the address of the keypad is 2.

3 Wiring and Installation

- Dimension
 - Wiring
- Note: Hybrid control panel does not support Z1, GND, NO/NC, COM.
c. Install Keypad
- Gangbox Mounting
 - Wall Mounting
- ★ It is required to insert the screw for tamper alarm.

4 Operation Commands

Scan the QR code a to get operation commands of Hybrid control panel.

Specification

Model	DS-PK-L	DS-PK-LR	DS-PK-LRT	DS-PK-LRTE
Numeric key	12 keys: 0 to 9, *, #			
Function key	8 keys: Project/Query/Bypass/One-push to arm/Fire/Panic/Scroll up/Scroll down			
Display	LCD screen			
Keypad	N/A	N/A	Two-way keypad	Two-way keypad
Tamper switch	1			
RS-485 interface	1			
Sound	buzzer			
Tag/Card reading	N/A	N/A	Support	Support
Power supply	12 V, 0.15 A			
Power consumption	1.8 W			
Temperature	-10 °C to 55 °C			
Humidity	10% to 90%			
Dimension (L × W × H)	164 mm × 124 mm × 31 mm			
Weight	272 g			

Legal and Regulatory Information



1

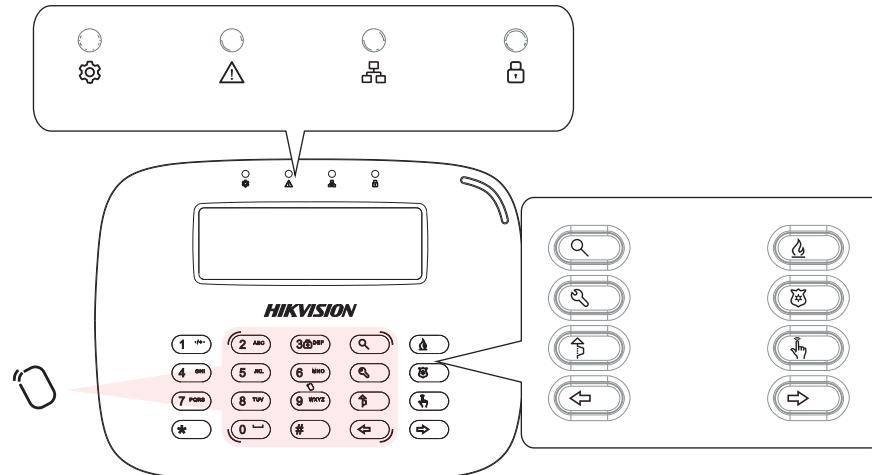

2

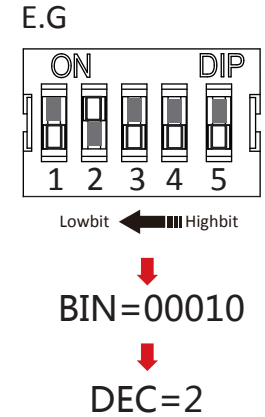

3

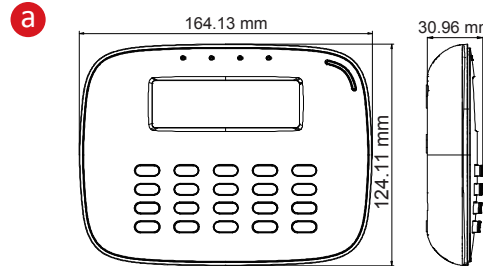

c

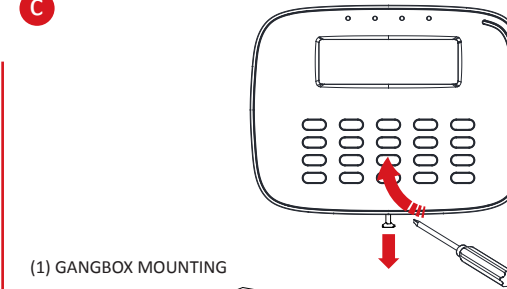

4

